

Hallberg Rassy 44

Welcome onboard the Hallberg Rassy 44

Hallberg-Rassy 44 is the sailboat that takes your sailing adventures to the next level with its impressive construction and superior performance. Tradition and innovation meet in a harmonious balance between comfort and functionality. The Hallberg-Rassy 44 is not just a boat, it's a lifestyle. Equipped with everything you need to explore the seven seas, the Hallberg-Rassy 44 offers an unbeatable combination of comfort, performance, and safety. Experience the freedom of setting sail with Hallberg-Rassy.



LOA	BEAM	DISPLACEMENT	KEEL WEIGHT	ENGINE
14,45 m	4,20 m	13.300 kg	5300 kg	VP D2-75
DRAFT	SAIL AREA	DESIGN	YEAR MODEL	WATER
2,1m	109 m ²	German Frers	2018	745 l
CE-CATEGORY		DIESEL		
A-UNLIMITED		420 l		

Hallberg Rassy 44

Below is a selection from a comprehensive equipment list. For more information, please contact Knapemarín.

Hull & Deck

- Laminate construction of hull: Isophthalic gelcoat, vinylester-based barrier coat
- Insulated with Divinycell PVC-foam (except keel area, which is solid laminate)
- Integrated rubbing strake with brass strip
- Blue decorative band in gelcoat
- Lead keel
- Bolted with numerous stainless steel bolts
- Strong engine foundations of GRP for effective sound insulation
- Deck and coachroof areas of sandwich construction, solid in parts, laminated to the hull
- Cockpit of sandwich construction, solid in parts, laminated to the hull
- Four hull portlights
- Air-conditioning and Webasto heating system

Machinery & Propulsion

- Volvo Penta D2-75 engine, 55 kW/75 HP, 4 cylinder, 2.2 liters
- Mounted on four rubber feet for minimal vibration and noise
- Hydraulic transmission with 3 bladed folding propeller
- Fresh water cooled engine with a 40 L hot water tank
- Automatic fire extinguisher and bilge pump in engine room
- Bow thruster
- Stern thruster

Hallberg Rassy 44

Standing rig

- Triple spreader rig by Seldén.
- In-mast furling.
- Under deck genoa jib furling and reefing system Seldén Furlex TD.
- Seldén rod kicker and backstay tensioner.
- One winch for reefing, self-tailing, for main- and genoa jib halyards.
- Several cleats for various uses.
- Generous dimensions of standing and running rigging for ocean sailing.
- Turnbuckles from Seldén, winches from Lewmar.
- Windex wind indicator and anchor light on mast top.
- Carbon spinnaker pole

Sails

- North sails 3Di main -2023
- North sails 3Di genoa -2023
- Furling Code 0.

Navigation & electronics

- Chartplotter: Raymarine Axiom 12 with European maps
- Autopilot: Raymarine p70 / Type II
- AIS: Raymarine AIS650 class-B transponder
- Instruments: 3x Raymarine i70s, 1x i60 wind
- Radar: Raymarine Quantum Q24C radar
- Cameras: Raymarine Cam 210 and Cam 220 on spreaders
- Antenna: VHF antenna with cable to navigation table
- VHF Radio: Raymarine VHF Ray260e, DSC class D with 2 stations
- Stereo: Fusion DVD stereo with fixed remote on steering pedestal

Hallberg Rassy 44

AC/DC

- Lithium batteries
- Shore power charger
- 2 pcs 115A alternators installed on the engine for fast recharge of lithium service battery bank.
- Lighting throughout the boat with adjustable reading lights above berths.
- Electric 12 V sockets at inner chart table and in the cockpit.
- Electric panel with circuit breakers at inner chart table.
- Water and diesel meters.
- LED navigation lights, steaming light, and anchor light.

Hallberg Rassy 44

Layout

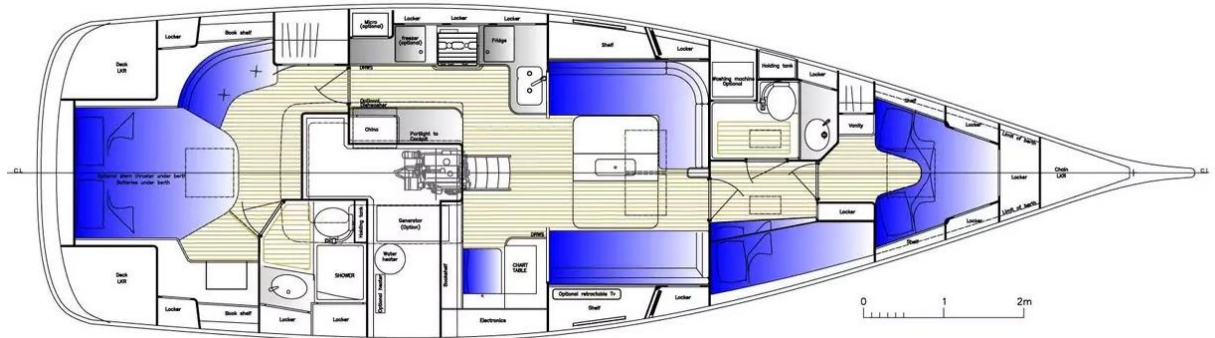

- **Saloon:**

- Settee for comfortable seating.
- Port side: 2.00 m long L-sofa with backrests that can be used as storage.
- Starboard side: 2.00 m long settee, backrest can be lifted for sleeping.
- Strong table with foldable sides and top opening bar.
- Headroom approximately 1.97 m.
- Air-conditioning in saloon

- **Galley:**

- Corian working surface with mahogany fiddle rail.
- Insulated cooling box with water-cooled electric compressor.
- Extra deep double sink.
- Two-burner gas cooker with oven, gimballed and safety features.
- Crockery locker, cutlery drawer, bread board.
- Room for kitchen utensils and waste bin.

- **Forward Heads Compartment:**

- White laminate bulkheads and lockers.
- Grating, wash basin, and Corian countertop.
- Large mirror, shower with watertight stall, hand switch for safety.
- Reliable pump action toilet, holding tank.

Hallberg Rassy 44

Forward Cabin:

- Door arrangement for easy movement.
- Two 2.10 m long berths with ample stowage.
- Deck hatch, opening porthole, and lockers.

Work Table and Walkthrough:

- Comfortable work table seat, electric panel.
- Drawers, stowage slots, larger rubber sealed door to engine room.
- Good headroom, wet locker, and cupboards.

Aft Cabin:

- Double centre bed and seat.
- Private head with shower.
- Aft cabin air-conditioning.

There is a lot to be said about this well-maintained and well-equipped HR44. For more information and an even more detailed equipment list, do not hesitate to contact Knappe Marin.

